

**NORTHAMPTON BOROUGH COUNCIL**

**LICENSING ACT 2003**

**LICENSING SUB COMMITTEE**

A Meeting of the Licensing Sub-Committee will be held at The Council Chamber, St. Giles Square, Northampton, NN1 1DE. on Wednesday, 15 August 2018 at 10:00 am

**George Candler**  
**Chief Executive**

**AGENDA**

- 1. WELCOMES**
- 2. DECLARATIONS OF INTEREST**
- 3. VARIATION OF PREMISES LICENCE APPLICATION**
- 4. LICENSING ACT 2003 (HEARINGS) REGULATIONS 2005**

To consider whether the Panel should exclude the public from all or part of the hearing during consideration of any item listed above if the Panel believe that the public interest in doing so outweighs the public interest in the hearing, or that part of the hearing, taking place in public, in accordance with regulation 14 of the Licensing Act 2003 (Hearings) Regulations 2005.

## PROCEDURES FOR LICENSING SUB-COMMITTEE HEARING

- **Welcome** – Chairman welcomes the Applicant, Representors, Responsible Authorities and Interested Parties and introduces members of the sub-committee (+ other officers e.g. Solicitor, Licensing Officer, Democratic Services Officer etc).
- **Declarations of Interest by Councillors**
- **Reason for Hearing** – to be outlined by the **Licensing Officer** or the **Chair**.
- **Format of the hearing** – an explanation of the format of the proceedings:
  1. **Applicant** (or his/her representative) will address the sub-committee first and put their case.
  2. **The Chair** leads an examination of the **Applicant's case**. First, the panel may ask questions and then the Chair invites Responsible and Interested Parties to participate. Questions may only relate to the points made by the applicant.
  3. **The Representors/Respondents** (and responsible and Interested Parties) then state their case.
  4. **The Chair** leads an examination of the **Representor's case**.

Each party will be given an equal maximum period of time in which to present their case and may, if given permission by the Chair, question any other party.

- **Summing Up**
  - By the Representors/Respondents
  - By the Applicant
- **Sub-committee retires** – and may call for the Solicitor for advice if required.
- **Sub-Committee deliver their decision and reasons for their decision at the conclusion of the meeting IF:**
  1. Application for conversion of existing licence
  2. Application for conversion of existing club certificate
  3. Application by holder of justices' licence for grant of personal licence
  4. Application for conversion and variation of premises licence (including variation of DPS)
  5. Application for conversion and variation of club premises certificate
  6. Counter notice following police objection to temporary event notice
  7. Review of Premises Licence following Closure Order

In all other cases, the Sub-committee delivers its decision and reasons for its decision within five working days beginning with the day on which the hearing was held.

**If you require any further information regarding this meeting please contact Democratic Services on 01604 837722 or [democraticservices@northampton.gov](mailto:democraticservices@northampton.gov)**



## VARIATION OF PREMISES LICENCE APPLICATION

### Licensing Sub-Committee

Wednesday 15 August 2018

#### 1.0 Purpose of Report

- 1.1 To consider an application for the variation of the premises licence for The Turkish Social Club, 4 Henry Street, Northampton NN1 4JE.

#### 2.0 Summary

- 2.1 An application for the variation of a premises licence was submitted on behalf of The Turkish Social Club by Mr John Birch as an agent on behalf of Cahit Menekse who is the Designated Premises Supervisor under the licence. The application was received by Northampton Borough Council on the 3 July 2018. A premises licence was originally granted to the Turkish Social Club on 8 April 2014 under licence number PL1035. (Appendix A).

#### 3.0 Application Details

- 3.1 The variation application was submitted with the intention to extend the single storey ground floor to the rear of the existing to provide an additional area for licensable activities. The variation plan also includes an outside smoking area for consumption of alcohol and use of a previously disused basement for pool and similar activities. A copy of the application is attached as Appendix B and plan Appendix C.
- 3.2 The licensable activities and times granted for the original premises licence on 8 April 2014 are for the following;

**Sales of Alcohol for consumption On the premises:**

Monday – Sunday 10:00 – 02:00

**Late Night refreshment:**

Monday – Sunday 23:00- 02:00

**Opening Hours:**

Monday – Sunday 10:00 – 02:00

- 3.3 The Designated Premises Supervisor is:

**Mr Cahit Menekse**

**Personal Licence Number: PA2390**

#### 4.0 Consultations/Representations

- 4.1 When a request for the variation of a premises licence or club premises certificate is received, the applicant must display a notice at or near the

premises and serve a copy of the application onto the responsible authorities. For electronic applications it is a requirement of the local authority to serve a copy of the application onto the responsible authorities.

This gives responsible authorities and interested parties the opportunity to make representations in relation to the application for a period of 28 calendar days. The last date for representation was the 31 July 2018.

- 4.2 The obligatory notice was displayed on the premises as verified by licensing officers on the 14 July 2018 and in a local newspaper on the 12 July 2018. A copy of the notice is attached as Appendix D
- 4.3 The Licensing Department has received one relevant representation under the licensing objective of prevention of public nuisance from a local resident. A copy of the representation is attached as Appendix E
- 4.4. The Licensing Department has also received a representation from Environmental Health under the licensing objective of prevention of public nuisance. This representation has since been withdrawn following agreement between the applicant and the representor to end licensable activities in outside areas at 11.00pm on Mondays to Saturdays and 10.00pm on Sundays and Bank Holidays. A copy of the representation and subsequent agreement are attached as Appendix F.
- 4.4. The Planning Department responded to the application clarifying that the premises would require planning permission, however although an application had been submitted the outcome is still pending. A copy of the correspondence received is attached as Appendix G.
- 4.4 Northamptonshire Police have considered the application and have made no representations.

## **5.0 Attendance**

- 5.1 The local authority is required to send a notice of hearing to all interested parties and request confirmation of attendance. A notice of hearing was sent to the following persons on 3 August 2018.

**Member of Public – confirmation of attendance pending**

**John Birch on behalf of The Turkish Social Club – confirmation of attendance received.**

## **6.0 Plan of Premises Layout & Location**

Please see premises Plan and Location map attached as Appendix B.

## **7.0 Options**

7.1 At the end of the consultation period the licensing authority must hold a hearing. It must take such steps as it considers appropriate for the promotion of the licensing objectives, which are:

- the prevention of crime and disorder
- public safety
- the prevention of public nuisance
- the protection of children from harm

The steps the Sub-Committee can take are to:

- reject the whole or part of the application;
- To modify the conditions of the licence (excluding the mandatory conditions).

7.2 The Sub-Committee should note that, although the applicant has stated that they agree to the conditions referred to at paragraph 4.4 above, it is for the Licensing Sub-Committee to determine what conditions are added to the licence.

## **8.0 Policy Considerations**

8.1 Statement of Licensing Policy

8.2 s.182 Guidance Licensing Act 2003 (April 2018 version)

Section 9 gives guidance for determination of this application.

Sections 8 & 10 highlights the elements of the Guidance that are most relevant with respect to this application. This is not exhaustive and the Guidance should be considered fully prior to making decisions with respect to applications.

## **9.0 Committee**

Each application must be considered on its own merits and any conditions attached to licences and certificates must be tailored to the individual style and characteristics of the premises and events concerned. This is essential to avoid the imposition of disproportionate and overly burdensome conditions on premises where there is no need for such conditions. Standardised conditions should be avoided and indeed, may be unlawful where they cannot be shown to be appropriate for the promotion of the licensing objectives in any individual case.

<b>Appendix No</b>	<b>Title</b>
<b>A.</b> <b>B.</b> <b>C.</b> <b>D.</b> <b>E.</b> <b>F</b> <b>G</b>	Premises Licence PL1035 – The Turkish Social Club  Variation Application  Plan of proposed extension and location map.  Public notice  Representation from member of public  Representation from Environmental Health and agreement reached  Correspondence from Planning Department
<b>Report Author</b>	Ian Ellis Senior Licensing Enforcement Officer

Appendix A

Licensing Act 2003 **PL1035**  
**Premises Licence**

LOCAL AUTHORITY	
 NORTHAMPTON BOROUGH COUNCIL	<b>Licensing Section</b> <b>The Guildhall</b> <b>St Giles Square</b> <b>NORTHAMPTON</b> <b>NN1 1DE</b>

Part 1 - Premises Details

POSTAL ADDRESS OF PREMISES, OR IF NONE, ORDNANCE SURVEY MAP REFERENCE OR DESCRIPTION
<b>The Turkish Social Club</b> 4 Henry Street, Northampton, NN1 4JE.

WHERE THE LICENCE IS TIME LIMITED THE DATES
Not applicable

LICENSABLE ACTIVITIES AUTHORISED BY THE LICENCE
<ul style="list-style-type: none"> <li>- provision of late night refreshment</li> <li>- the sale by retail of alcohol</li> </ul>

THE TIMES THE LICENCE AUTHORIZES THE CARRYING OUT OF LICENSABLE ACTIVITIES			
Activity (and Area if applicable)	Description	Time From	Time To
L. Late night refreshment (Indoors)	Monday-Sunday Non Standard Timings: New Years Eve until 0300 on Jan 1st	11:00pm	2:00am
M. The sale by retail of alcohol for consumption ON the premises only	Monday-Sunday Non Standard Timings: New Years Eve until 0300 Jan 1st	10:00am	2:00am

THE OPENING HOURS OF THE PREMISES			
Description	Time From	Time To	
Monday-Sunday Non Standard Timings: New Years Eve until 03:30 on 1st Jan	10:00am	2:00am	

WHERE THE LICENCE AUTHORIZES SUPPLIES OF ALCOHOL WHETHER THESE ARE ON AND / OR OFF SUPPLIES
- M. The sale by retail of alcohol for consumption ON the premises only

Part 2

NAME, (REGISTERED) ADDRESS, TELEPHONE NUMBER AND EMAIL (WHERE RELEVANT) OF HOLDER OF PREMISES LICENCE	
Cahit Menekse <a href="mailto:menekse1@hotmail.co.uk">menekse1@hotmail.co.uk</a>	76 Mendip Road, Northampton, NN5 6AZ.





Licensing Act 2003  
**Premises Licence**

**PL1035**

REGISTERED NUMBER OF HOLDER, FOR EXAMPLE COMPANY NUMBER, CHARITY NUMBER (WHERE APPLICABLE)

NAME, ADDRESS AND TELEPHONE NUMBER OF DESIGNATED PREMISES SUPERVISOR WHERE THE PREMISES LICENCE AUTHORISES THE SUPPLY OF ALCOHOL

Cahit MENEKSE

78 Mendip Road, Northampton, NN5 6AZ

PERSONAL LICENCE NUMBER AND ISSUING AUTHORITY OF PERSONAL LICENCE HELD BY DESIGNATED PREMISES SUPERVISOR WHERE THE PREMISES LICENCE AUTHORISES FOR THE SUPPLY OF ALCOHOL

Licence No. PA2390

Issued by Northampton

**ANNEXES**

**ADDITIONAL MANDATORY CONDITIONS.**

The following mandatory conditions are to be applied to the licence stated above in accordance with section 3 (1) of The Licensing Act 2003 (Mandatory Licensing Conditions) Order 2010.

**The following conditions shall come into force on 6th April 2010**

1. (1) The responsible person shall take all reasonable steps to ensure that staff on relevant premises do not carry out, arrange or participate in any irresponsible promotions in relation to the premises.

(2) In this paragraph, an irresponsible promotion means any one or more of the following activities, or substantially similar activities, carried on for the purpose of encouraging the sale or supply of alcohol for consumption on the premises in a manner which carries a significant risk of leading or contributing to crime and disorder, prejudice to public safety, public nuisance, or harm to children-

(a) games or other activities which require or encourage, or are designed to require or encourage, individuals to-

(i) drink a quantity of alcohol within a time limit (other than to drink alcohol sold or supplied on the premises before the cessation of the period in which the responsible person is authorised to sell or supply alcohol), or

(ii) drink as much alcohol as possible (whether within a time limit or otherwise);

(b) provision of unlimited or unspecified quantities of alcohol free or for a fixed or discounted fee to the public or to a group defined by a particular characteristic (other than any promotion or discount available to an individual in respect of alcohol for consumption at a table meal, as defined in section 159 of the Act;

(c) provision of free or discounted alcohol or any other thing as a prize to encourage or reward the purchase and consumption of alcohol over a period of 24 hours or less;

(d) provision of free or discounted alcohol in relation to the viewing on the premises of a sporting event, where that provision is dependent on-

(i) the outcome of a race, competition or other event or process, or

(ii) the likelihood of anything occurring or not occurring;

(e) selling or supplying alcohol in association with promotional posters or flyers on, or in





ANNEXES continued ...

the vicinity of, the premises which can reasonably be considered to condone, encourage or glamorise anti-social behaviour or to refer to the effects of drunkenness in any favourable manner.

2. The responsible person shall ensure that no alcohol is dispensed directly by one person into the mouth of another (other than where that other person is unable to drink without assistance by reason of a disability).

3. The responsible person shall ensure that free tap water is provided on request to customers where it is reasonably available.

The following mandatory conditions are to be applied to the licence stated above in accordance with section 3 (1) of The Licensing Act 2003 (Mandatory Licensing Conditions) Order 2010.

**The following conditions shall come into force on 1st October 2010**

4. (1) The premises licence holder or club premises certificate holder shall ensure that an age verification policy applies to the premises in relation to the sale or supply of alcohol.

(2) The policy must require individuals who appear to the responsible person to be under 18 years of age (or such older age as may be specified in the policy) to produce on request, before being served alcohol, identification bearing their photograph, date of birth and a holographic mark.

5. The responsible person shall ensure that-

(a) where any of the following alcoholic drinks is sold or supplied for consumption on the premises (other than alcoholic drinks sold or supplied having been made up in advance ready for sale or supply in a securely closed container) it is available to customers in the following measures-

- (i) beer or cider: 1/2 pint;
- (ii) gin, rum, vodka or whisky: 25 ml or 35 ml; and
- (iii) still wine in a glass: 125 ml; and

(b) customers are made aware of the availability of these measures.

**ANNEX 1 - MANDATORY CONDITIONS**

**Mandatory conditions where licence authorises supply of alcohol**

(1) No supply of alcohol may be made under the premises licence -

(a) at a time when there is no designated premises supervisor in respect of the premises licence, or

(b) at a time when the designated premises supervisor does not hold a personal



ANNEXES continued ...

licence or his personal licence is suspended.

- (2) Every supply of alcohol under the premises licence must be made or authorised by a person who holds a personal licence.

**Conditions of Operating Schedule**

The Licence Holder will ensure the promotion of the licensing objectives forms an integral part of the day to day management of the premises

A CCTV system is in operation that complies to the Data Protection Act 1988. The CCTV system is recording at all times the premises is open for business. Recordings are kept for 28 days and a person who is trained in how to use the system is on duty to retrieve recordings upon reasonable request of an authorised officer.

Bottle skips will not be emptied outside between 2200 and 0700.

A working intruder alarm is in operation.

The Think 21 Age Verification protocol is in operation whereby anyone who appears not to be 18 years of age or older must produce ID in the form of a Photographic Driving Licence, Passport, HM Forces ID Card or an ID Card incorporating the PASS hologram

A refusals record is kept up to date and will be produced upon request of an authorised officer



Solicitor to the Council



LOCAL AUTHORITY	
 <p><b>NORTHAMPTON</b> BOROUGH COUNCIL</p>	<p>Licensing Section The Guildhall St Giles Square NORTHAMPTON NN1 1DE</p>

## Premises Details

POSTAL ADDRESS OF PREMISES, OR IF NONE, ORDNANCE SURVEY MAP REFERENCE OR DESCRIPTION			
<p><b>The Turkish Social Club</b> 4 Henry Street, Northampton, NN1 4JE.</p>			
WHERE THE LICENCE IS TIME LIMITED THE DATES			
Not applicable			
LICENSABLE ACTIVITIES AUTHORISED BY THE LICENCE			
<ul style="list-style-type: none"> <li>- provision of late night refreshment</li> <li>- the sale by retail of alcohol</li> </ul>			
THE TIMES THE LICENCE AUTHORISES THE CARRYING OUT OF LICENSABLE ACTIVITIES			
Activity (and Area if applicable)	Description	Time From	Time To
L. Late night refreshment (Indoors)	Monday-Sunday Non Standard Timings: New Years Eve until 0300 on Jan 1st	11:00pm	2:00am
M. The sale by retail of alcohol for consumption ON the premises only	Monday-Sunday Non Standard Timings: New Years Eve until 0300 Jan 1st	10:00am	2:00am
THE OPENING HOURS OF THE PREMISES			
Description	Time From	Time To	
Monday-Sunday Non Standard Timings: New Years Eve until 03:30 on 1st Jan	10:00am	2:00am	
WHERE THE LICENCE AUTHORISES SUPPLIES OF ALCOHOL WHETHER THESE ARE ON AND / OR OFF SUPPLIES			
- M. The sale by retail of alcohol for consumption ON the premises only			
NAME, (REGISTERED) ADDRESS OF HOLDER OF PREMISES LICENCE			
Cahit Menekse		76 Mendip Road, Northampton, NN5 6AZ.	
REGISTERED NUMBER OF HOLDER, FOR EXAMPLE COMPANY NUMBER, CHARITY NUMBER (WHERE APPLICABLE)			



Licensing Act 2003

# Premises Licence Summary

# PL1035

NAME OF DESIGNATED PREMISES SUPERVISOR WHERE THE PREMISES LICENCE AUTHORISES THE SUPPLY OF ALCOHOL

Cahit MENEKSE

STATE WHETHER ACCESS TO THE PREMISES BY CHILDREN IS RESTRICTED OR PROHIBITED





# Appendix B



**Northampton**  
**Application to vary a premises licence**  
**Licensing Act 2003**

For help contact  
[licensing@northampton.gov.uk](mailto:licensing@northampton.gov.uk)  
Telephone:

\* required information

**Section 1 of 18**

You can save the form at any time and resume it later. You do not need to be logged in when you resume.

System reference  This is the unique reference for this application generated by the system.

Your reference  You can put what you want here to help you track applications if you make lots of them. It is passed to the authority.

Are you an agent acting on behalf of the applicant?  
 Yes  No Put "no" if you are applying on your own behalf or on behalf of a business you own or work for.

**Applicant Details**

\* First name

\* Family name

\* E-mail

Main telephone number  Include country code.

Other telephone number

Indicate here if the applicant would prefer not to be contacted by telephone

Is the applicant:  
 Applying as a business or organisation, including as a sole trader  
 Applying as an individual

A sole trader is a business owned by one person without any special legal structure. Applying as an individual means the applicant is applying so the applicant can be employed, or for some other personal reason, such as following a hobby.



Continued from previous page...

**Address**

\* Building number or name

\* Street

District

\* City or town

County or administrative area

\* Postcode

\* Country

**Agent Details**

\* First name

\* Family name

\* E-mail

Main telephone number

Other telephone number

Include country code.

Indicate here if you would prefer not to be contacted by telephone

Are you:

- An agent that is a business or organisation, including a sole trader
- A private individual acting as an agent

A sole trader is a business owned by one person without any special legal structure.

**Your Address**

Address official correspondence should be sent to.

\* Building number or name

\* Street

District

\* City or town

County or administrative area

\* Postcode

\* Country

**Section 2 of 18**

**APPLICATION DETAILS**

Continued from previous page...

**This application cannot be used to vary the licence so as to extend the period for which the licence has effect or to vary substantially the premises to which it relates. If you wish to make that type of change to the premises licence, you should make a new premises licence application under section 17 of the Licensing Act 2003.**

I/we, as named in section 1, being the premises licence holder, apply to vary a premises licence under section 34 of the Licensing Act 2003 for the premises described in section 2 below.

\* Premises Licence Number

Are you able to provide a postal address, OS map reference or description of the premises?

Address     OS map reference     Description

**Postal Address Of Premises**

Building number or name

Street

District

City or town

County or administrative area

Postcode

Country

**Premises Contact Details**

Telephone number

Non-domestic rateable value of premises (£)

**Section 3 of 18**

**VARIATION**

Do you want the proposed variation to have effect as soon as possible?     Yes     No

Do you want the proposed variation to have effect in relation to the introduction of the late night levy?     Yes     No

You do not have to pay a fee if the only purpose of the variation for which you are applying is to avoid becoming liable to the late night levy.

If your proposed variation would mean that 5,000 or more people are expected to attend the premises at any one time, state the number expected to attend

**Describe Briefly The Nature Of The Proposed Variation**

**Continued from previous page...**

Describe the premises. For example the type of premises, its general situation and layout and any other information which could be relevant to the licensing objectives. Where your application includes off-supplies of alcohol and you intend to provide a place for consumption of these off-supplies, you must include a description of where the place will be and its proximity to the premises.

SINGLE STOREY GROUND FLOOR EXTENSION TO THE REAR OF EXISTING WHICH WILL PROVIDE ADDITIONAL AREA FOR LICENSABLE ACTIVITIES. (NO CHANGES TO ACTIVITIES OR HOURS) AMENDED PLAN ALSO SHOWS OUTSIDE SMOKING AREA FOR CONSUMPTION OF ALCOHOL AND USE OF PREVIOUSLY DISUSED BASEMENT FOR POOL AND SIMILAR INDOOR SPORTING EVENTS

**Section 4 of 18**

**PROVISION OF PLAYS**

See guidance on regulated entertainment

Will the schedule to provide plays be subject to change if this application to vary is successful?

Yes  No

**Section 5 of 18**

**PROVISION OF FILMS**

See guidance on regulated entertainment

Will the schedule to provide films be subject to change if this application to vary is successful?

Yes  No

**Section 6 of 18**

**PROVISION OF INDOOR SPORTING EVENTS**

See guidance on regulated entertainment

Will the schedule to provide indoor sporting events be subject to change if this application to vary is successful?

Yes  No

**Section 7 of 18**

**PROVISION OF BOXING OR WRESTLING ENTERTAINMENTS**

See guidance on regulated entertainment

Will the schedule to provide boxing or wrestling entertainments be subject to change if this application to vary is successful?

Yes  No

**Section 8 of 18**

**PROVISION OF LIVE MUSIC**

See guidance on regulated entertainment

Will the schedule to provide live music be subject to change if this application to vary is successful?

Yes  No

**Section 9 of 18**

**PROVISION OF RECORDED MUSIC**

<i>Continued from previous page...</i>	See guidance on regulated entertainment
<p>Will the schedule to provide recorded music be subject to change if this application to vary is successful?</p> <p><input type="radio"/> Yes                      <input checked="" type="radio"/> No</p>	
<b>Section 10 of 18</b>	
<b>PROVISION OF PERFORMANCES OF DANCE</b>	
<p>See guidance on regulated entertainment</p> <p>Will the schedule to provide performances of dance be subject to change if this application to vary is successful?</p> <p><input type="radio"/> Yes                      <input checked="" type="radio"/> No</p>	
<b>Section 11 of 18</b>	
<b>PROVISION OF ANYTHING OF A SIMILAR DESCRIPTION TO LIVE MUSIC, RECORDED MUSIC OR PERFORMANCES OF DANCE</b>	
<p>See guidance on regulated entertainment</p> <p>Will the schedule to provide anything similar to live music, recorded music or performances of dance be subject to change if this application to vary is successful?</p> <p><input type="radio"/> Yes                      <input checked="" type="radio"/> No</p>	
<b>Section 12 of 18</b>	
<b>PROVISION OF LATE NIGHT REFRESHMENT</b>	
<p>Will the schedule to provide late night refreshment be subject to change if this application to vary is successful?</p> <p><input type="radio"/> Yes                      <input checked="" type="radio"/> No</p>	
<b>Section 13 of 18</b>	
<b>SUPPLY OF ALCOHOL</b>	
<p>Will the schedule to supply alcohol be subject to change if this application to vary is successful?</p> <p><input type="radio"/> Yes                      <input checked="" type="radio"/> No</p>	
<b>Section 14 of 18</b>	
<b>ADULT ENTERTAINMENT</b>	
<p>Highlight any adult entertainment or services, activities, or other entertainment or matters ancillary to the use of the premises that may give rise to concern in respect of children.</p> <p>Provide information about anything intended to occur at the premises or ancillary to the use of the premises which may give rise to concern in respect of children, regardless of whether you intend children to have access to the premises, for example (but not exclusively) nudity or semi-nudity, films for restricted age groups etc gambling machines etc.</p>	
<p>NONE</p>	
<b>Section 15 of 18</b>	
<b>HOURS PREMISES ARE OPEN TO THE PUBLIC</b>	

Continued from previous page...

**Standard Days And Timings**

MONDAY

Start

End

Start

End

Provide timings in 24 hour clock (e.g., 16:00) and only give details for the days of the week when you intend the premises to be used for the activity.

TUESDAY

Start

End

Start

End

WEDNESDAY

Start

End

Start

End

THURSDAY

Start

End

Start

End

FRIDAY

Start

End

Start

End

SATURDAY

Start

End

Start

End

SUNDAY

Start

End

Start

End

State any seasonal variations.

For example (but not exclusively) where the activity will occur on additional days during the summer months.

Non standard timings. Where you intend to use the premises to be open to the members and guests at different times from those listed above, list below.

For example (but not exclusively), where you wish the activity to go on longer on a particular day e.g. Christmas Eve.

NEW YEAR'S EVE UNTIL 03.30 ON 1 JANUARY



*Continued from previous page...*

Identify those conditions currently imposed on the licence which you believe could be removed as a consequence of the proposed variation you are seeking.

NONE

- I have enclosed the premises licence  
 I have enclosed the relevant part of the premises licence

Reasons why I have failed to enclose the premises licence or relevant part of premises licence.

REGRET LOST

**Section 16 of 18**

**LICENSING OBJECTIVES**

Describe the steps you intend to take to promote the four licensing objectives:

a) General – all four licensing objectives (b,c,d,e)

List here steps you will take to promote all four licensing objectives together.

AS LISTED BELOW

b) The prevention of crime and disorder

NO ADDITIONAL MEASURES

c) Public safety

INFORMATION ONLY:THE FIRE RISK ASSESSMENT WILL BE UPDATED TO REASSESS THE RISK ARISING FROM THE PROPOSED USE OF THE BASEMENT & TO DETAIL APPLIANCES & EQUIPMENT REQUIRED

d) The prevention of public nuisance

NO ADDITIONAL MEASURES

e) The protection of children from harm

Continued from previous page...

NO ADDITIONAL MEASURES

**Section 17 of 18**

**NOTES ON REGULATED ENTERTAINMENT**

In terms of specific **regulated entertainments** please note that:

- Plays: no licence is required for performances between 08:00 and 23.00 on any day, provided that the audience does not exceed 500.
- Films: no licence is required for 'not-for-profit' film exhibition held in community premises between 08.00 and 23.00 on any day provided that the audience does not exceed 500 and the organiser (a) gets consent to the screening from a person who is responsible for the premises; and (b) ensures that each such screening abides by age classification ratings.
- Indoor sporting events: no licence is required for performances between 08.00 and 23.00 on any day, provided that the audience does not exceed 1000.
- Boxing or Wrestling Entertainment: no licence is required for a contest, exhibition or display of Greco-Roman wrestling, or freestyle wrestling between 08.00 and 23.00 on any day, provided that the audience does not exceed 1000. Combined fighting sports – defined as a contest, exhibition or display which combines boxing or wrestling with one or more martial arts – are licensable as a boxing or wrestling entertainment rather than an indoor sporting event.
- Live music: no licence permission is required for:
  - a performance of unamplified live music between 08.00 and 23.00 on any day, on any premises.
  - a performance of amplified live music between 08.00 and 23.00 on any day on premises authorised to sell alcohol for consumption on those premises, provided that the audience does not exceed 500.
  - a performance of amplified live music between 08.00 and 23.00 on any day, in a workplace that is not licensed to sell alcohol on those premises, provided that the audience does not exceed 500.
  - a performance of amplified live music between 08.00 and 23.00 on any day, in a church hall, village hall, community hall, or other similar community premises, that is not licensed by a premises licence to sell alcohol, provided that (a) the audience does not exceed 500, and (b) the organiser gets consent for the performance from a person who is responsible for the premises.
  - a performance of amplified live music between 08.00 and 23.00 on any day, at the non-residential premises of (i) a local authority, or (ii) a school, or (iii) a hospital, provided that (a) the audience does not exceed 500, and (b) the organiser gets consent for the performance on the relevant premises from: (i) the local authority concerned, or (ii) the school or (iii) the health care provider for the hospital.
- Recorded Music: no licence permission is required for:
  - any playing of recorded music between 08.00 and 23.00 on any day on premises authorised to sell alcohol for consumption on those premises, provided that the audience does not exceed 500.
  - any playing of recorded music between 08.00 and 23.00 on any day, in a church hall, village hall, community hall, or other similar community premises, that is not licensed by a premises licence to sell alcohol, provided that (a) the audience does not exceed 500, and (b) the organiser gets consent for the performance from a person who is responsible for the premises.
  - any playing of recorded music between 08.00 and 23.00 on any day, at the non-residential premises of (i) a local authority, or (ii) a school, or (iii) a hospital, provided that (a) the audience does not exceed 500, and (b) the organiser gets consent for the performance on the relevant premises from: (i) the local authority concerned, or (ii) the school proprietor or (iii) the health care provider for the hospital.

**Continued from previous page...**

- Dance: no licence is required for performances between 08.00 and 23.00 on any day, provided that the audience does not exceed 500. However, a performance which amounts to adult entertainment remains licensable.
- Cross activity exemptions: no licence is required between 08.00 and 23.00 on any day, with no limit on audience size for:
  - o any entertainment taking place on the premises of the local authority where the entertainment is provided by or on behalf of the local authority;
  - o any entertainment taking place on the hospital premises of the health care provider where the entertainment is provided by or on behalf of the health care provider;
  - o any entertainment taking place on the premises of the school where the entertainment is provided by or on behalf of the school proprietor; and
  - o any entertainment (excluding films and a boxing or wrestling entertainment) taking place at a travelling circus, provided that (a) it takes place within a moveable structure that accommodates the audience, and (b) that the travelling circus has not been located on the same site for more than 28 consecutive days.

**Section 18 of 18**

**PAYMENT DETAILS**

This fee must be paid to the authority. If you complete the application online, you must pay it by debit or credit card.

Variation Fees are determined by the non-domestic rateable value of the premises.

To find out a premises non domestic rateable value go to the Valuation Office Agency site at [http://www.voa.gov.uk/business\\_rates/index.htm](http://www.voa.gov.uk/business_rates/index.htm)

Band A - No RV to £4300 £100.00

Band B - £4301 to £33000 £190.00

Band C - £33001 to £8700 £315.00

Band D - £87001 to £12500 £450.00\*

Band E - £125001 and over £635.00\*

\*If the premises rateable value is in Bands D or E and the premises is primarily used for the consumption of alcohol on the premises then you are required to pay a higher fee

Band D - £87001 to £12500 £900.00

Band E - £125001 and over £1,905.00

If you own a large premise you are subject to additional fees based upon the number in attendance at any one time

Capacity 5000-9999 £1,000.00

Capacity 10000 -14999 £2,000.00

Capacity 15000-19999 £4,000.00

Capacity 20000-29999 £8,000.00

Capacity 30000-39000 £16,000.00

Capacity 40000-49999 £24,000.00

Capacity 50000-59999 £32,000.00

Capacity 60000-69999 £40,000.00

Capacity 70000-79999 £48,000.00

Capacity 80000-89999 £56,000.00

Capacity 90000 and over £64,000.00

\* Fee amount (£)

100.00

**DECLARATION**

\* I/we understand it is an offence, liable on conviction to a fine up to level 5 on the standard scale, under section 158 of the licensing act 2003, to make a false statement in or in connection with this application.

Ticking this box indicates you have read and understood the above declaration

This section should be completed by the applicant, unless you answered "Yes" to the question "Are you an agent acting on behalf of the applicant?"

**Continued from previous page...**

\* Full name

\* Capacity

\* Date  /  /   
dd mm yyyy

Once you're finished you need to do the following:  
 1. Save this form to your computer by clicking file/save as..  
 2. Go back to <https://www.gov.uk/apply-for-a-licence/premises-licence/northampton/change-1> to upload this file and continue with your application.  
 Don't forget to make sure you have all your supporting documentation to hand.

**IT IS AN OFFENCE, UNDER SECTION 158 OF THE LICENSING ACT 2003, TO MAKE A FALSE STATEMENT IN OR IN CONNECTION WITH THIS APPLICATION. THOSE WHO MAKE A FALSE STATEMENT MAY BE LIABLE ON SUMMARY CONVICTION TO A FINE OF ANY AMOUNT.**

**OFFICE USE ONLY**

---

Applicant reference number

Fee paid

Payment provider reference

ELMS Payment Reference

Payment status

Payment authorisation code

Payment authorisation date

Date and time submitted

Approval deadline

Error message

Is Digitally signed

[1](#) [2](#) [3](#) [4](#) [5](#) [6](#) [7](#) [8](#) [9](#) [10](#) [11](#) [12](#) [13](#) [14](#) [15](#) [16](#) [17](#) [18](#) Next >

Appendix C

TURKISH SOCIAL CLUB, 4 HENRY STREET, NORTHAMPTON NN1 4JE  
PROPOSED EXTENSION

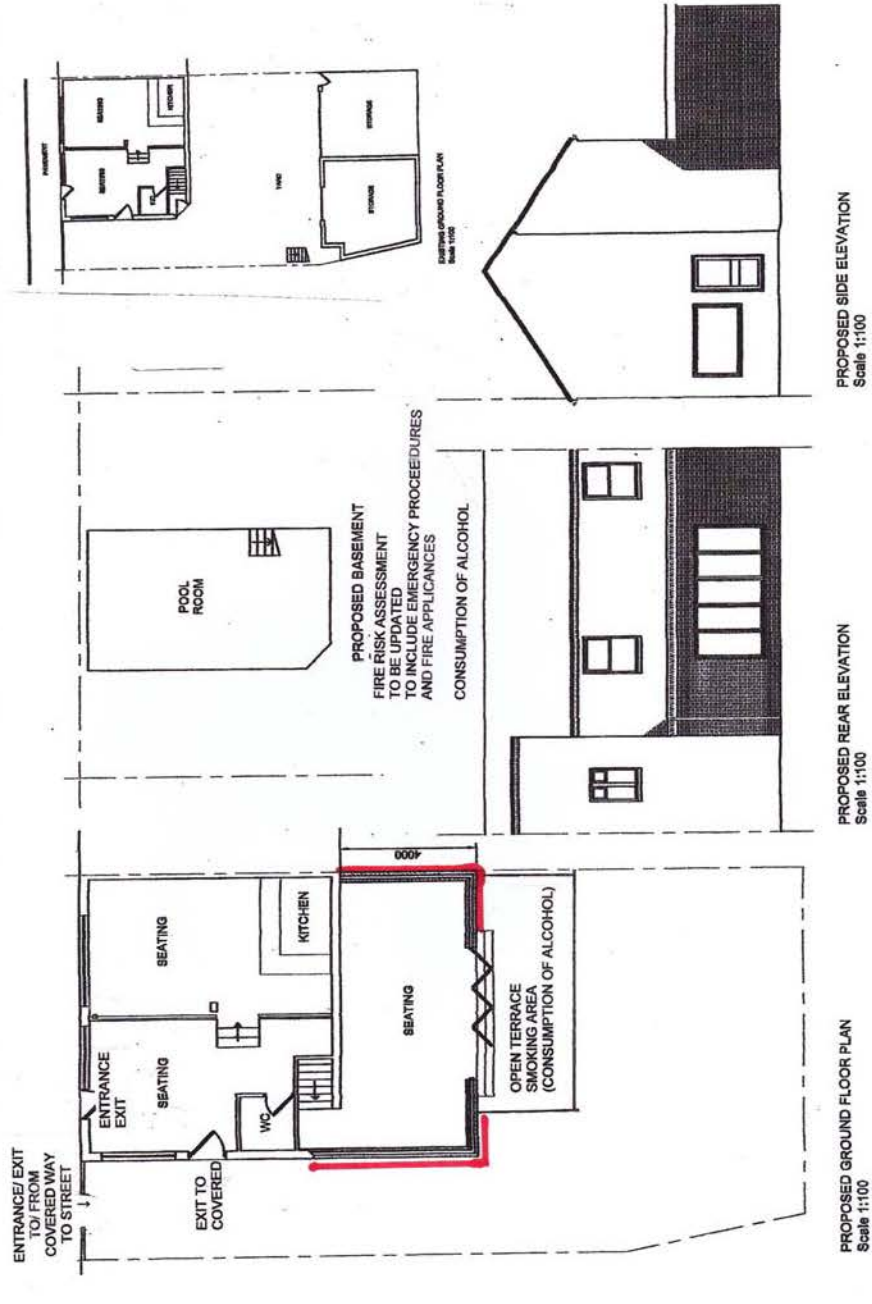



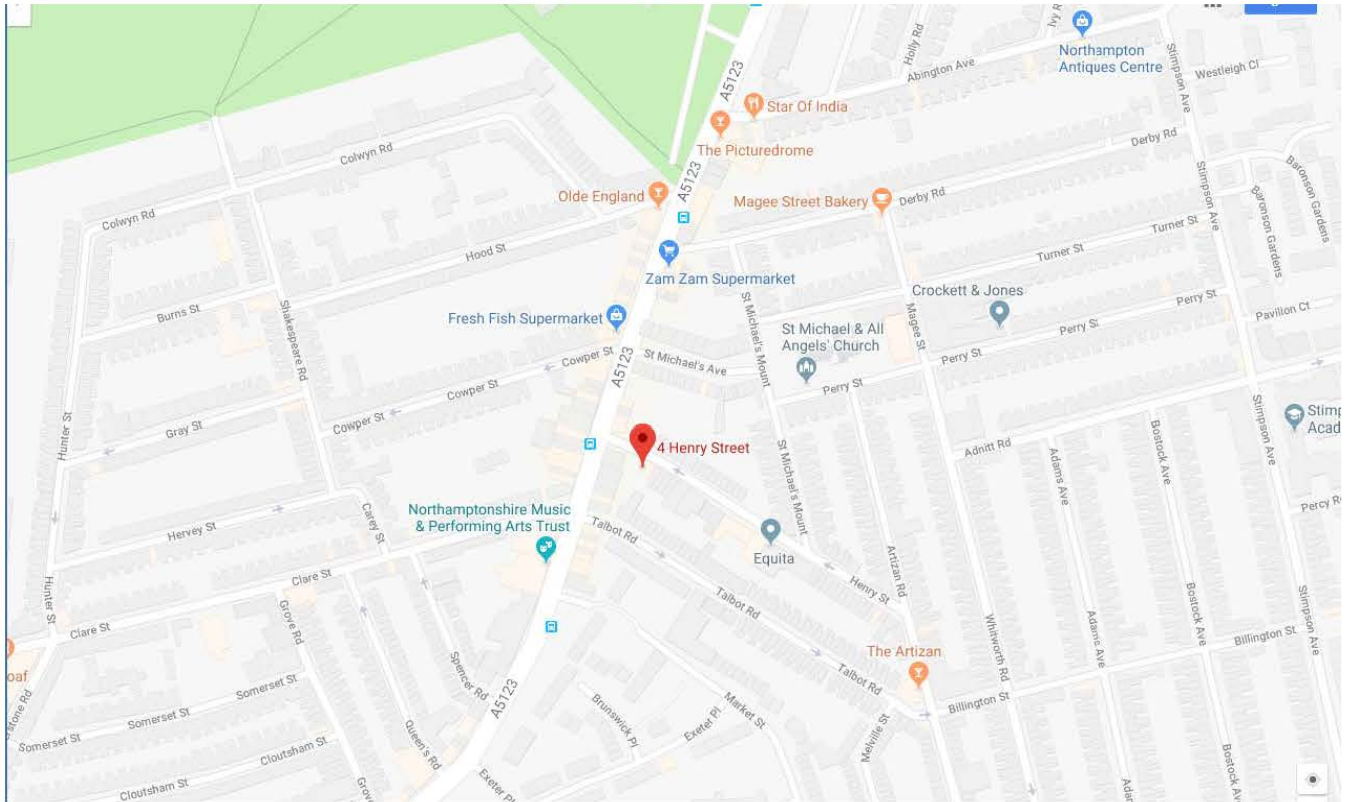

## Appendix D



## Appendix E

Northampton  
Northamptonshire  
NN1 4JE

30<sup>th</sup> July 2018

Northamptonshire Borough Council  
The Guildhall  
St Giles Square  
Northampton  
NN1 1DE

F.A.O Ian Ellis

Dear Sirs,

### **4 Henry Street – Variation Application 057376**

We are writing to you to register our objection to the Variation Application 057376 by 4 Henry Street Northampton. The basis for this opposition is that granting the variation to the license for these premises will not promote the licensing objectives, particularly the prevention of public nuisance.

We live [REDACTED] a block of terraced houses.

Our biggest concern with regards to the Variation Application is the noise levels. On quite a number of occasions we have posted polite notices through the door to ask them to keep the noise down which they have blatantly ignore. We both work 9-5 jobs and as you can imagine trying to get to sleep with the noise they are making is already difficult, our concerns are that this extension is going to cause more disruption and I fear this will start to affect our work. We feel that they are not respectful to us and other members of the street when they are banging doors, shouting and generally just causing a nuisance to us [REDACTED]

Another concern we have is the litter and smoking, we are at a point where we have had to close our Living room window because people loiter outside the front of the house smoking, when we have asked them to move they have just ignored us. On a weekly basis we have to sweep outside our house because people have littered outside our window and I have watched them first hand go back into 4 Henry Street, our bin day is a Monday and there is always rubbish outside the property before this, as you can imagine in the summer especially, it is not nice, we cannot have our Living Room window open because of the odour of rubbish and smoke.

Parking is another issue, as I am sure you are fully aware we live on a terraced street where parking is limited anyway, with this Variation Application we feel this is going to cause us an even bigger problem. Why should we not be able to park outside of our house in a residential street because of the business next door?

In view of the above, I would urge the Licensing Authority to refuse the application.

Yours Faithfully

[REDACTED]

## Appendix F

**Ian Ellis**

---

**From:** John Birch <[REDACTED]>  
**Sent:** 02 August 2018 17:50  
**To:** Louise Marshall; Ian Ellis  
**Cc:** Licensing Enforcement  
**Subject:** Re: Turkish Club, Henry Street

Ian

On behalf of the applicant please may I agree with the proposed additional conditions  
John

**From:** [Louise Marshall](#)  
**Sent:** Thursday, August 2, 2018 4:35 PM  
**To:** [Ian Ellis](#)  
**Cc:** [Licensing Enforcement](#) ; [John Birch](#)  
**Subject:** Turkish Club, Henry Street

Dear Ian

### **Variation of Premises Licence – Turkish Social Club, Henry Street**

Further to previous emails, I confirm that Environmental Health is withdrawing the objection to the above application on the basis that the following conditions have been agreed with the applicant

1. All licensable activities shall cease in outside areas after 11pm Monday-Saturday and after 10pm on Sundays and Bank Holidays
2. All doors and windows at the rear of the premises shall be kept closed after 11pm Monday-Saturday and after 10pm on Sundays and Bank Holidays other than when it is necessary to allow access and egress of people. Doors must be closed immediately afterwards.

Please let me know if you need any more info

Many thanks,  
Louise

Mrs Louise Marshall  
Senior Environmental Health Officer  
Customers & Communities (Regulatory Services)  
Tel: [REDACTED]  
[REDACTED]

Northampton Borough Council  
The Guildhall (1st Floor) St Giles Square, Northampton NN1 1DE

Please note that the contents of this e-mail, including any attachments thereto, may contain information which is confidential or privileged, and which is solely for the use of the recipient named above. The information contained in this e-mail, and in your reply, may be subject to disclosure under the Freedom of Information Act 2000 or other legislation, and its confidentiality cannot be guaranteed. If you are not the

## Appendix G

**Ian Ellis**

---

**From:** Kanchan Sharma  
**Sent:** 13 July 2018 13:03  
**To:** Louise Faulkner  
**Subject:** RE: NBC - LA03 - VARIATION - TURKISH SOCIAL CLUB HENRY ST

Hi Louise,

Thank you for the consultation on the variation of the license for this Turkish Social Club.

The proposed single storey extension will require Planning permission. We have received the application but it is still being validated and the outcome is pending.

I hope that is of some assistance, please let me know if you would require any further information.

Kind Regards,  
Kanchan



Kanchan Sharma  
Planning Officer  
Northampton Borough Council | Development Management  
The Guildhall | St Giles Square | Northampton | NN1 1DE  
t: [REDACTED] | e: [REDACTED]

### Customer Feedback

We would like your feedback to help us maintain and continually improve the standard of services we provide. As a customer of the **Regeneration, Enterprise and Planning Directorate** it would help us if you could take a moment to complete the online [survey](#) about your experience. Any personal information you do provide to us will be held on a computer database. Your personal information will only be used by, and on behalf of, Northampton Borough Council in improving the service we provide to our customers. If the hyperlink above does not work then please copy and paste this address into your internet browser: <https://www.surveymonkey.com/r/RepSatisfaction>



**From:** Louise Faulkner  
**Sent:** 04 July 2018 15:49  
**To:** Building Control <[REDACTED]>; 'Children & Family Service' <[REDACTED]>;  
<[REDACTED]>; Environmental Protection <[REDACTED]>; 'HEALTH'  
<[REDACTED]>; 'HOME OFFICE' <[REDACTED]>; Louise Marshall  
<[REDACTED]>; Natasha Stanley <[REDACTED]>; 'Northants Fire & Rescue'